

MATERIAL HANDLING EQUIPMENT

Reliable & Safe Equipment

TDI understands how important it is for your plant to have reliable and safe material handling equipment — available and ready — to move products and supplies effectively and efficiently. TDI sources and supplies various types and designs of surplus material handling equipment to meet your application. Prior to being delivered to your facility, each piece of material handling equipment is passed through the TDI Shop where it is carefully inspected, cleaned, painted and packaged for transport. Non-destructive testing services and certification can be provided by an independent source upon request.

Below is a list of the different categories of used material handling devices that TDI has available. The highlighted items from the list are described further in detail along with the equipment attributes. These attributes are an important part of sizing up a unit so that it will meet your specific application.

C-Hooks

Cars

Coil Grabs/Tongs

Crane Trollies

Cranes

Hooks

Locomotive Diesel Electric Cranes

Slab Haulers

Stacking—Bundling—Banding

Turnstiles

Weigh Scales

Car Pullers

Coil Compactor

Coil Haulers / Tractors

Crane Wheels

Hook Blocks

Hot Metal Torpedo Type Transfer Cars

Lifting Magnets

Spreader Lift Beams

Trackmobiles

Uprender/Downender

C-Hooks

What: Standard C-Hooks are designed for heavy duty applications and are used in the metals industry to pick up coils.

Capacity: 4 to 30 Ton Capacities
Can be of welded or cast construction

Attributes: Opening Throat Opening Width
Opening Eye Dimensions Overall Length
Width of Hook Height of Hook

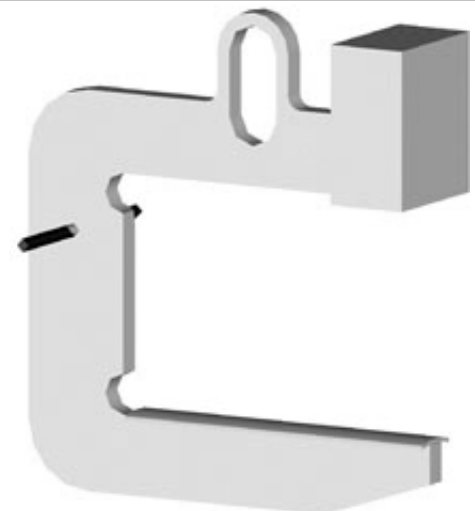
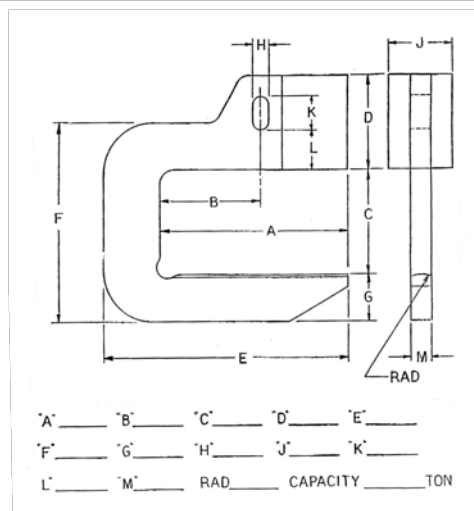

EXPERIENCE WORKS.



TDI
MILL EQUIPMENT
TDIGRP.COM

P.O. Box 38657
Pittsburgh, PA 15238
PH 412.826.4950
FX 412.826.4959

SEARCH THE TDI EQUIPMENT DATABASE ONLINE AT www.tdigrp.com

Coil Grabs/Tongs:

What:	Rotating & Non-Rotating, Coil Grabs and Tongs are used in “below-the-hook” material handling applications for efficient handling of coils.	
Capacity:	1 Ton to 30 Ton Capacities	
Attributes:	Electro-Mechanical or Hydraulic Operations	
	Capacity	Hook Centers
	Grab Centers	Cable Diameter
	Min/Max Opening	Arm Length to Top of Shoe
	Shoe Height	Top of Shoe to Top of Base

Automatic Vertical
Coil Tong

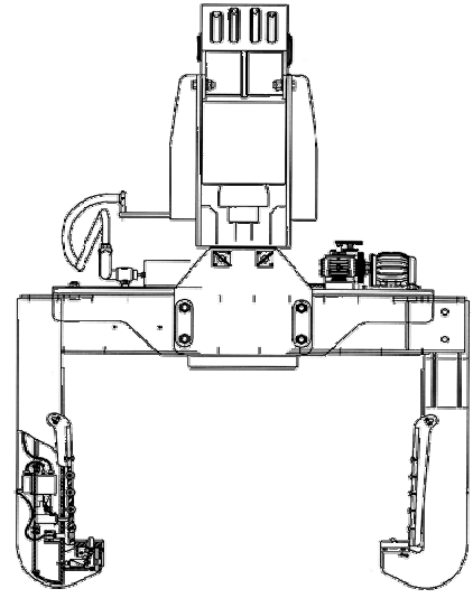
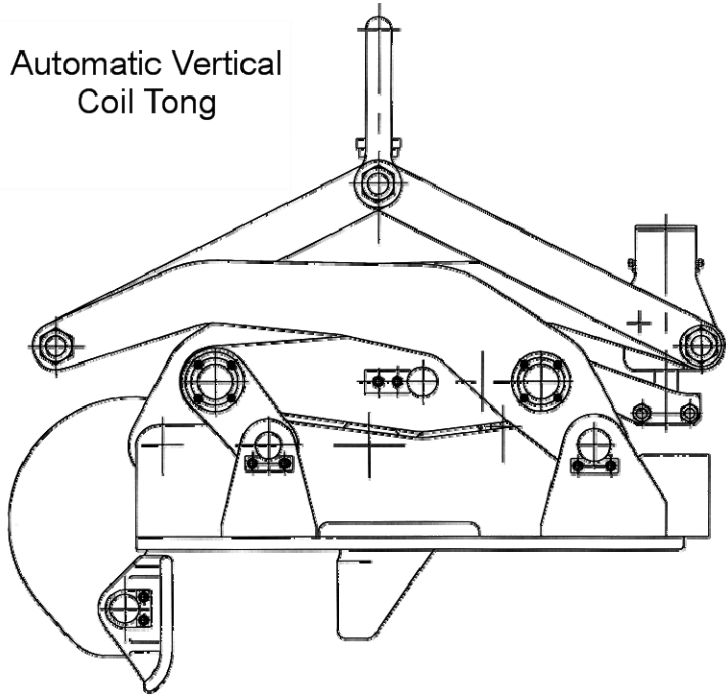

Motorized Horizontal Coil Tong

Lifting Magnets

What:	Used to lift and transfer scrap or finished iron and steel without slings, hooks or cables.	
Capacity:	Available in circular, rectangular, square and hot billet types	
Attributes:	Voltage/Amps	Resistance
	Winding	Weight
	Ohms	Duty Cycle
	Insulations	



Hook Blocks

What:	A Hook Block is the lower sheave or block on a crane hoist to which a swivel hook is attached.	
Capacity:	4 Ton to 60 Ton with varying number of sheaves	
Attributes:	Capacity	Hook
	Sheave Pitch Diameter	No. of Sheaves
	Rope Size Diameter	Bearings
	Safety Latch	

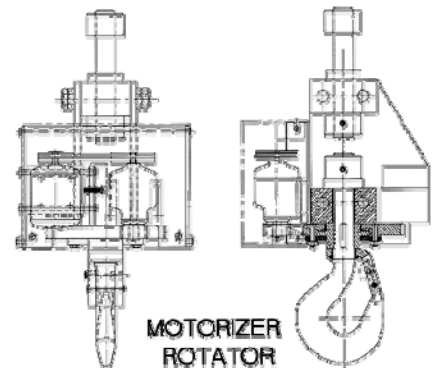

“Watch for future bulletins covering additional Material Handling Equipment”